

18 Bryncatwg , Neath, SA10 8BG

Situated within the popular village of Cadoxton, close to local primary/secondary schools, Neath Port Talbot College, the popular Aberdulais Waterfalls, easy access for the M4 motorway and a short drive from all facilities at Neath Town Centre, a well presented semi detached 2/3 bedroom house set over 3 storeys offering versatile family living, benefitting from full gas central heating and double glazing throughout with integral single garage, gardens to front and rear and off road parking for one vehicle. The property comprises: entrance hallway and spacious lounge to the ground floor, kitchen, family bathroom and dining room/bedroom 3 to the first floor and a further two double bedrooms to the second floor. Viewing comes recommended

£187,950

18 Bryncatwg

, Neath, SA10 8BG



- EPC RATING D
- DINING ROOM/BEDROOM 3
- BATHROOM
- SOUGHT AFTER AREA
- SEMI DETACHED HOUSE
- LOUNGE
- SINGLE INTEGRAL GARAGE
- 2/3 BEDROOMS
- KITCHEN
- OUTSTANDING VIEWS

Main Dwelling

Ground Floor

Entrance Hallway

6'6" x 6'0" (1.99 x 1.85)

Lounge

15'7" x 12'4" (4.77 x 3.77)

Second Floor Landing Area

5'6" x 10'9" (1.69 x 3.30)

Kitchen

9'8" x 10'8" (2.97 x 3.26)

Family Bathroom

6'9" x 8'3" (2.06 x 2.54)

Dining Room/Bedroom 3

9'11" x 11'1" (3.04 x 3.40)

Second Landing Area

4'3" x 6'0" (1.32 x 1.85)

Bedroom One

15'8" x 10'3" (4.78 x 3.13)

Bedroom Two

12'4" x 8'3" (3.78 x 2.53)

Paved Patio Area

Rear Garden

Summer House

Views from Summer House

Front Garden

Integral Garage

Views to front



Directions

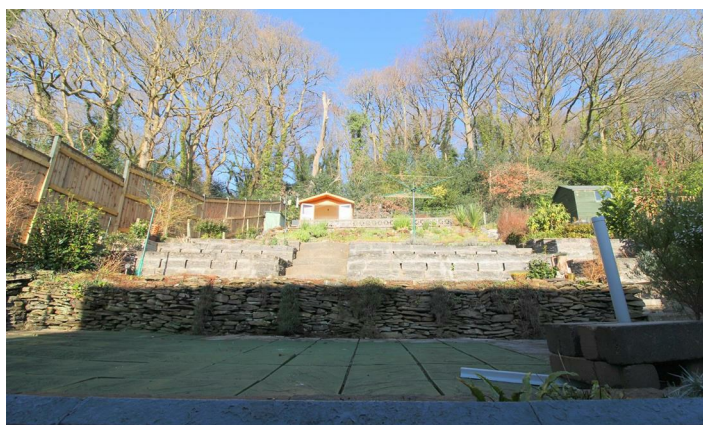

Floor Plan

Ground Floor

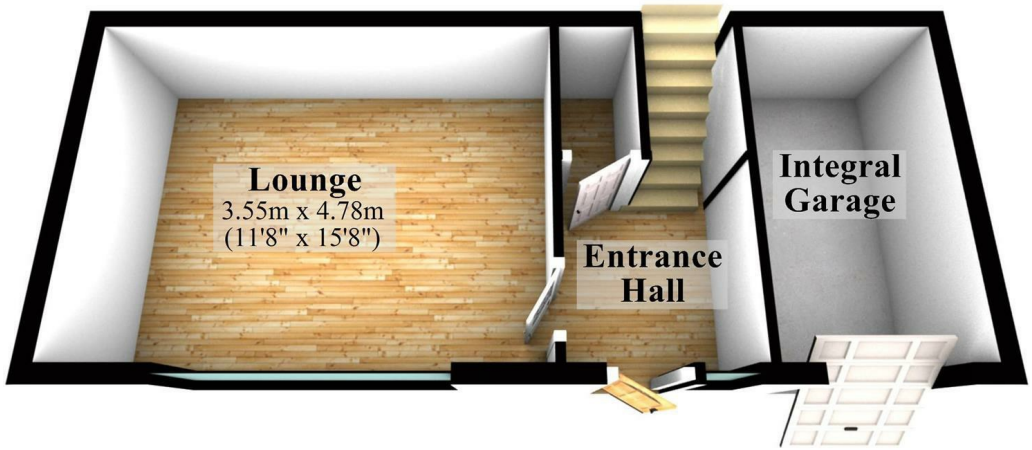

First Floor

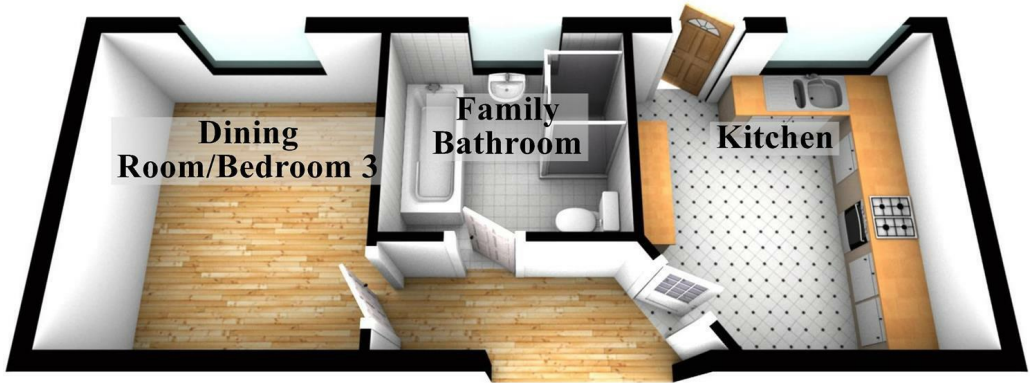

These particulars, whilst believed to be accurate are set out as a general outline only for guidance and do not constitute any part of an offer or contract. Intending purchasers should not rely on them as statements of representation of fact, but must satisfy themselves by inspection or otherwise as to their accuracy. No person in this firms employment has the authority to make or give any representation or warranty in respect of the property.

